

This lane will be used as a holding lane whereby all vehicles will be inspected to ensure the correct any vehicle entering Queens Gate Road has the correct permit/label. Any vehicle not displaying a label will be directed into the outside lane to rejoin Queens Roundabout

Used Primarily as an exit lane. This lane will be used to either direct non-permit holders to the correct gate/car park, or for non airshow vehicles to gain access to Queens Roundabout.

LANE 1& 2 - Dedicated bus lane. Only buses for the Airshow will be permitted to use the right turn lanes at these signals. All other permit holders/vehicles will be directed straight ahead to the next roundabout.

All Airshow permit holders/residents ect will be directed to continue straight ahead, and then complete a 'U' turn when advised.

Crossing Point Closed

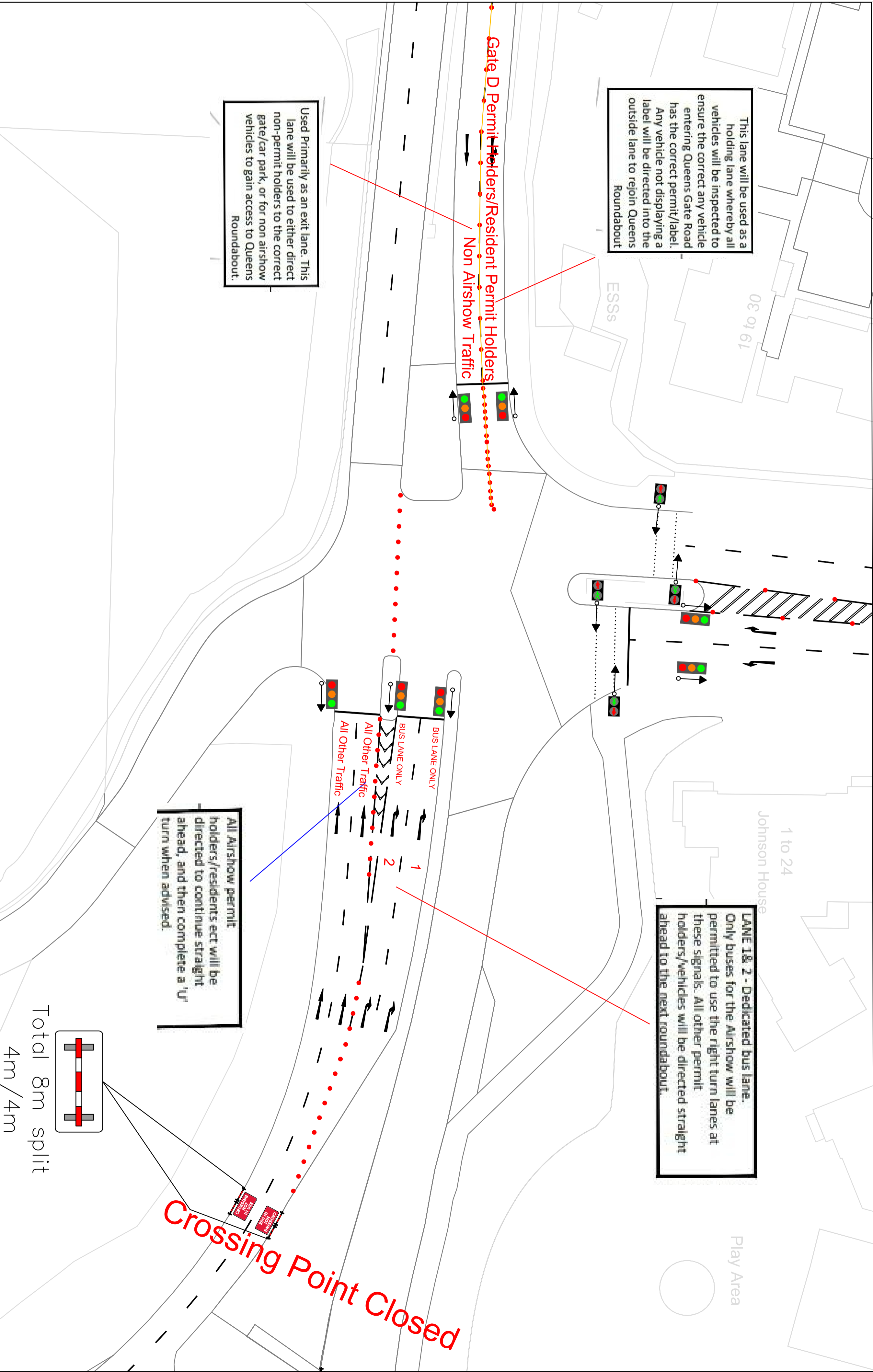

Total 8m split
4m / 4m

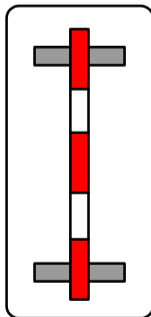

Event Traffic Solutions

Forum House
Basingstoke
Hants,
RG21 4EA



AIRSHOW
22-26 JULY 2024

CLASSIFICATION:	LOW
Project	Government House Road
Issue	Version 1
Date	15/4/24

Drawing	Not to Scale
---------	--------------

By Chris Wakefield
AA Signs
07738 792870
christopher.wakefield@theaaa.com